

|  |   |              |                                      |
|--|---|--------------|--------------------------------------|
|  | <b>Product Information</b><br><b>SP-10(850)</b> | Manufacturer | CNP                                  |
|  |   | Address      | Yuhang District, Hangzhou, Zhejiang, |
| Project Name   |   | Contact      | 86-571-88637351                      |
|  |   | Date         | 2022/03/08                           |
| Item NO  |   | Client Name  | DPA                                  |
|  |   | Client Addr. |                                      |
|  |   | Contacts     | Alireza                              |
|  |   | Contact      |                                      |

|          |            |
|----------|------------|
| Part NO. | 1100061840 |
|----------|------------|

| Product Picture   | Note   |
|---|--|
|  | <p>Single-stage non-clogging self-priming sewage pump with open impeller structure and non-clogging design, axial suction and radial discharge. Using the pull-type structure, maintenance without removing the pump and piping.</p> |

|                            |                |
|----------------------------|----------------|
| <b>technology</b>          |                |
| Pump rotator speed         | 850            |
| Nameplate standards        | CE             |
| <b>Material</b>            |                |
| Impeller                   | QT400-18       |
| Rubber code                | P              |
| <b>Installation</b>        |                |
| Maximum Operation Pressure | 0.37MPa        |
| Maximum Altitude           | 1000M          |
| <b>Medium</b>              |                |
| Maximum diameter of partic | 76mm           |
| Medium PH Value            | 5~9            |
| Medium Density             | ≤1.2*103kg/m3  |
| Maximum Environment Temper | ≤40            |
| Liquid Temperature Range   | 040            |
| <b>Structure dimension</b> |                |
| Inlet Bore                 | 250mm          |
| Outlet Diameter            | 250mm          |
| <b>Motor</b>               |                |
| Number of Motor Phase      | Three Phase    |
| Protection Class           | IP55           |
| Insulation Class           | F              |
| Motor Power                | 22KW           |
| Power Frequency            | 50HZ           |
| Rated Voltage (V)          | 380V           |
| Rated Current (A)          | 41.1A          |
| Energy Efficiency Level    | IE2            |
| <b>Seal</b>                |                |
| Mechanical Seal            | SP-1 7/8/WWF14 |
| <b>Others</b>              |                |
| Weight of Pump             | 705            |

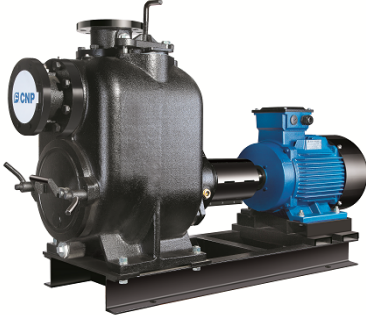

# Performance Curve SP-10(850)

|              |                                      |
|--------------|--------------------------------------|
| Manufacturer | CNP                                  |
| Address      | Yuhang District, Hangzhou, Zhejiang, |
| Contact      | 86-571-88637351                      |
| Date         | 2022/03/08                           |
| Client Name  | DPA                                  |
| Client Addr. |                                      |
| Contacts     | Alireza                              |
| Contact      |                                      |

The hydraulic performance curve have been tested with Clean Water at 20°C, density 1000kg/m<sup>3</sup>, and at 1bar atmospheric pressure. ISO99062012 Grade 3B

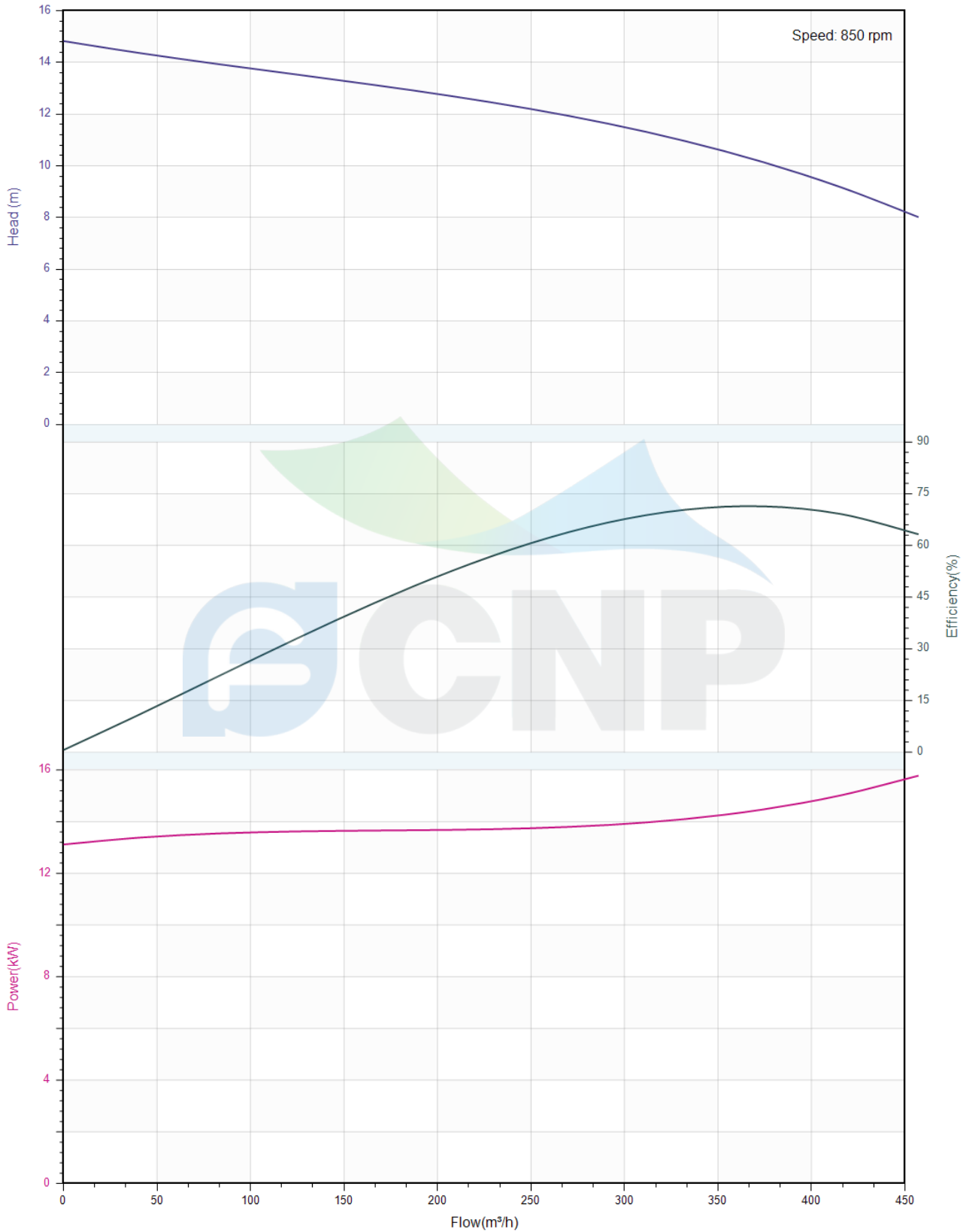



## Pump Technical Parameters SP-10(850)

|              |                                      |
|--------------|--------------------------------------|
| Manufacturer | CNP                                  |
| Address      | Yuhang District, Hangzhou, Zhejiang, |
| Contact      | 86-571-88637351                      |
| Date         | 2022/03/08                           |
| Client Name  | DPA                                  |
| Client Addr. |                                      |
| Contacts     | Alireza                              |
| Contact      |                                      |

### Rated parameters

|                                |            |
|--------------------------------|------------|
| Pump model                     | SP-10(850) |
| Part NO.                       | 1100061840 |
| Rated flow (m <sup>3</sup> /h) | 350        |
| Rated head (m)                 | 11         |
| Rated efficiency (%)           | 72         |
| Power (kW)                     | 14.57      |
| NPSHr (m)                      | 3.7        |
| Speed (rpm)                    | 850        |
| Max impeller diameter (mm)     | 382        |

### Medium

|                                     |             |
|-------------------------------------|-------------|
| Pumped medium                       | Clean Water |
| Working temperature (°C)            | 20          |
| Medium density (kg/m <sup>3</sup> ) | 1000        |
| Viscosity (mm <sup>2</sup> /s)      | 1           |

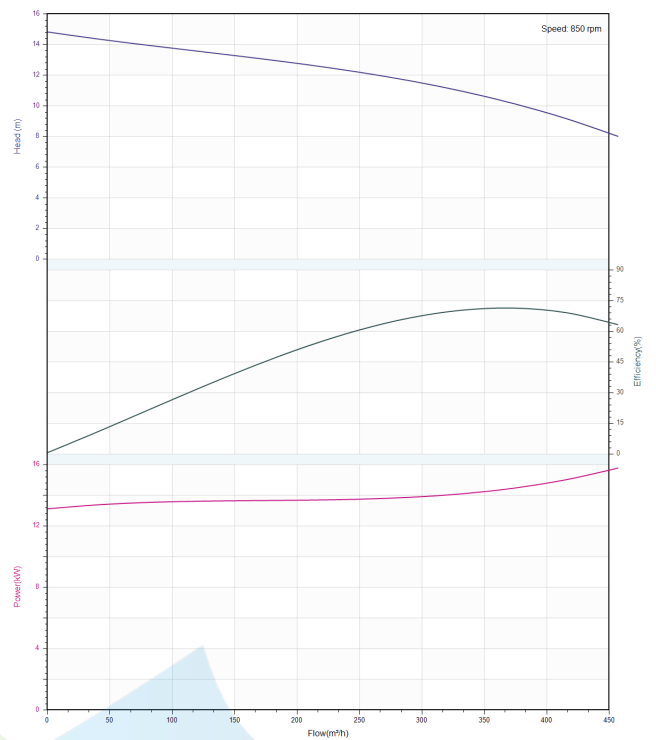



**Structure picture**  
**SP-10(850)**

|              |                                      |
|--------------|--------------------------------------|
| Manufacturer | CNP                                  |
| Address      | Yuhang District, Hangzhou, Zhejiang, |
| Contact      | 86-571-88637351                      |
| Date         | 2022/03/08                           |
| Client Name  | DPA                                  |
| Client Addr. |                                      |
| Contacts     | Alireza                              |
| Contact      |                                      |

Project Name

Item NO

新增-11。4。25

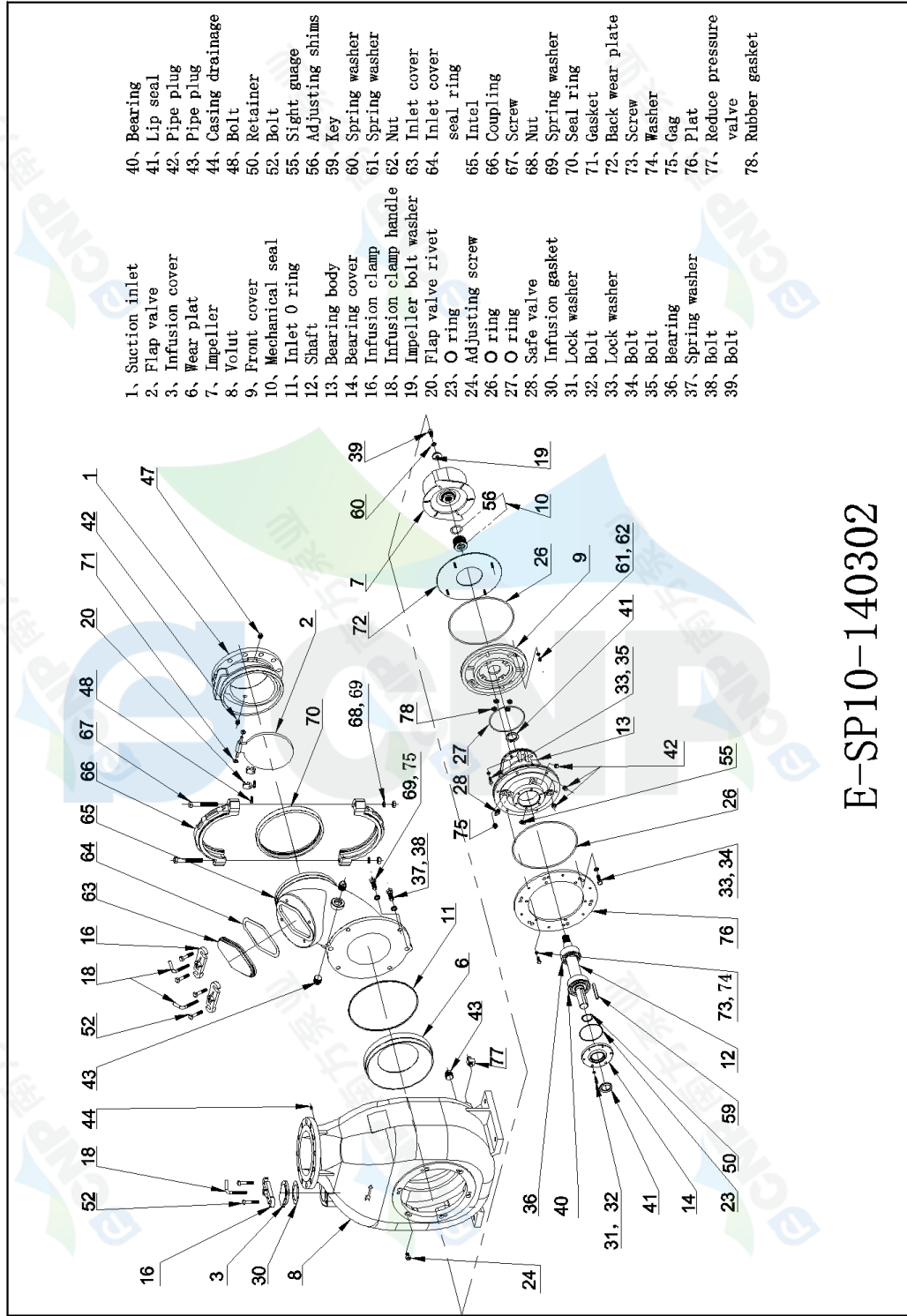

- 1, Suction inlet
- 2, Flap valve
- 3, Infusion cover
- 6, Wear plat
- 7, Impeller
- 8, Volut
- 9, Front cover
- 10, Mechanical seal
- 11, Inlet O ring
- 12, Shaft
- 13, Bearing body
- 14, Bearing cover
- 16, Infusion clamp
- 18, Infusion clamp handle
- 19, Impeller bolt washer
- 20, Flap valve rivet
- 23, O ring
- 24, Adjusting screw
- 26, O ring
- 27, O ring
- 28, Safe valve
- 30, Infusion gasket
- 31, Lock washer
- 32, Bolt
- 33, Lock washer
- 34, Bolt
- 35, Bolt
- 36, Bearing
- 37, Spring washer
- 38, Bolt
- 39, Bolt
- 40, Bearing
- 41, Lip seal
- 42, Pipe plug
- 43, Pipe plug
- 44, Casing drainage
- 48, Bolt
- 50, Retainer
- 52, Bolt
- 55, Sight guage
- 56, Adjusting shims
- 59, Key
- 60, Spring washer
- 61, Spring washer
- 62, Nut
- 63, Inlet cover
- 64, Inlet cover seal ring
- 65, Intel seal ring
- 66, Coupling
- 67, Screw
- 68, Nut
- 69, Spring washer
- 70, Seal ring
- 71, Gasket
- 72, Back wear plate
- 73, Screw
- 74, Washer
- 75, Gag
- 76, Plat
- 77, Reduce pressure valve
- 78, Rubber gasket

E-SP10-140302



**Dimension Drawing**  
**SP-10(850)**

|              |                                      |
|--------------|--------------------------------------|
| Manufacturer | CNP                                  |
| Address      | Yuhang District, Hangzhou, Zhejiang, |
| Contact      | 86-571-88637351                      |
| Date         | 2022/03/08                           |
| Client Name  | DPA                                  |
| Client Addr. |                                      |
| Contacts     | Alireza                              |
| Contact      |                                      |

Project Name

Item NO

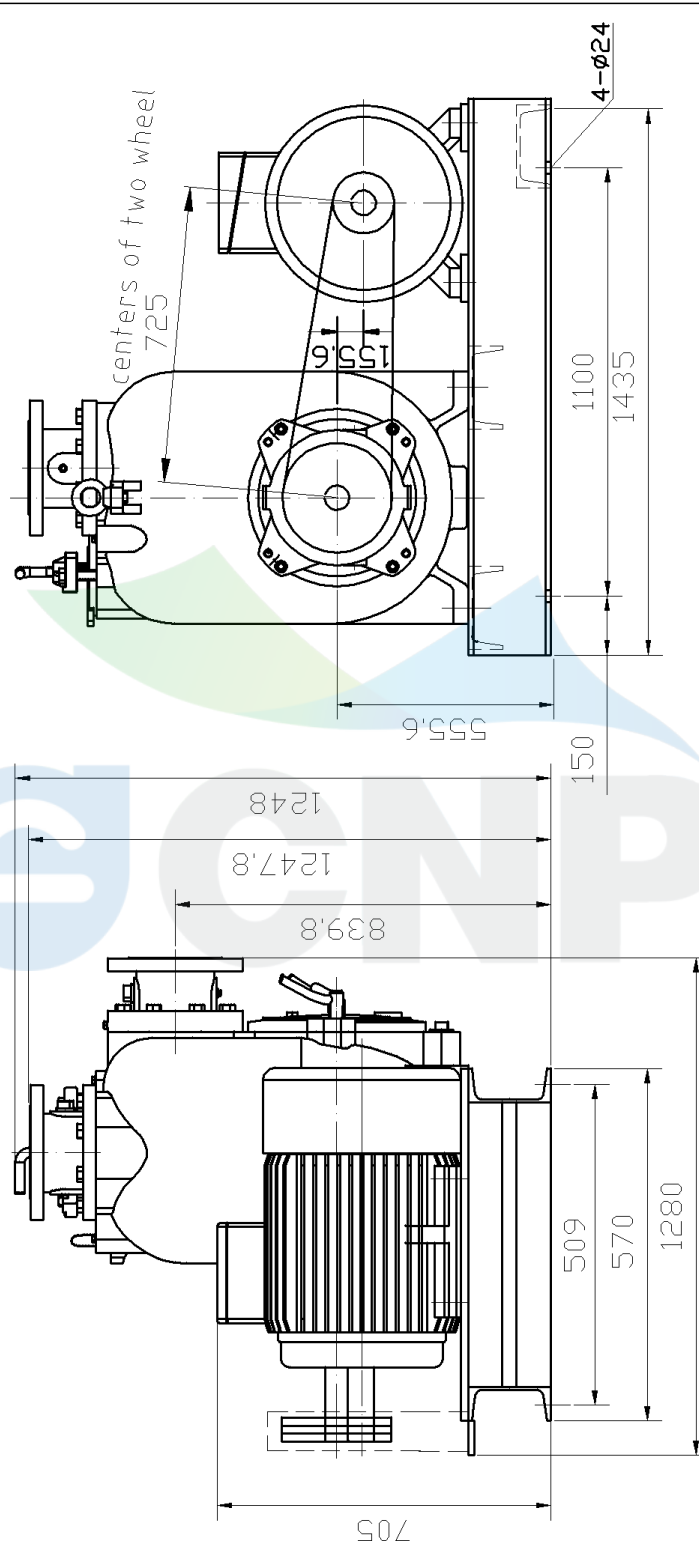

SP-10 850 RPM

|  |  |              |                                      |
|--|--|--------------|--------------------------------------|
|  | <b>Installation picture</b><br><b>SP-10(850)</b> | Manufacturer | CNP                                  |
|  |  | Address      | Yuhang District, Hangzhou, Zhejiang, |
| Project Name   |  | Contact      | 86-571-88637351                      |
|  |  | Date         | 2022/03/08                           |
| Item NO  |  | Client Name  | DPA                                  |
|  |  | Client Addr. |                                      |
|  |  | Contacts     | Alireza                              |
|  |  | Contact      |                                      |

# SP-10

GB/T17241.6-1998  
 DN250 PN1.6MPa

