	<b>Product Information</b>  <b>SJ75-19</b>	Manufacturer	Nanfang Pump Industry Co.,Ltd (CNP)
		Address	Hangzhou, Zhejiang, China
		Contact	86-571-88637351
		Date	2025/06/30
		Client Name	WEPKO
<b>Project Name</b>		Client Addr.	
<b>Item NO</b>		Contacts	Wepko
		Contact	

Part NO.	1100052480
----------	------------

Product Picture: (Note: Images may not be the same as the product)	Note
	<p>Stainless steel multi-stage submersible pump is equipped with a submersible motor which can replace traditional long axis Deep-well pump. The pump is also equipped with a check valve to protect itself from reflux and water hammer.</p>

### Nameplate parameters

Flow	75 m <sup>3</sup> /h
Head	257 m
Efficiency	73 %
Speed	2900 rpm
Number of stages	19

### Material

Impeller	304
Material Code	F

### Installation

Operation Pressure	38bar
Maximum Immersion Depth	70m
Maximum Operation Pressure	38bar

### Medium

Medium Temperature	15~40°C
Medium PH Value	6.5~8.5
Liquid Temperature Range	+25°C

### Structure dimension

Rotation Direction	Anti-clockwise rotation viewing from outlet
Expolded view	SJ75,95exploded view

### Motor

Number of Motor Phase	Three Phase
Protection Class	IP68
Insulation Class	F
Motor Power(kW)	75KW
Power Frequency(Hz)	50HZ
Rated Voltage (V)	380

### Others

Weight (kg)	346
-------------	-----

	<b>Performance Curve</b> <b>SJ75-19</b>	Manufacturer	Nanfang Pump Industry Co.,Ltd (CNP)
		Address	Hangzhou, Zhejiang, China
		Contact	86-571-88637351
		Date	2025/06/30
Project Name		Client Name	WEPKO
Item NO		Client Addr.	
		Contacts	Wepko
		Contact	

The hydraulic performance curve have been tested with water at 20°C, density 1000kg/m<sup>3</sup>,and at 1bar atmospherical pressure. ISO99062012 Grade 3B

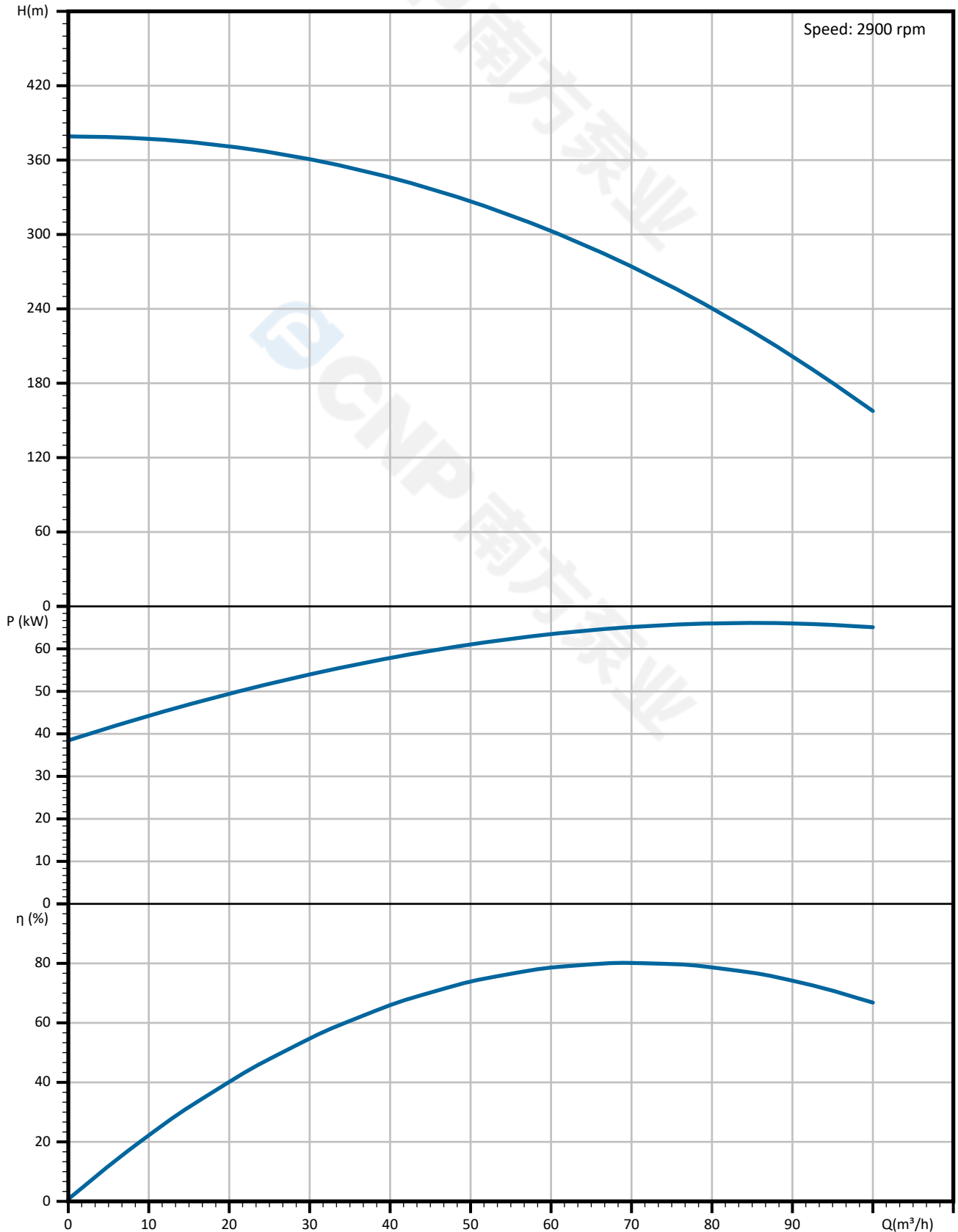

	<b>Pump Technical Parameters</b>  <b>SJ75-19</b>	Manufacturer	Nanfeng Pump Industry Co.,Ltd (CNP)
		Address	Hangzhou, Zhejiang, China
		Contact	86-571-88637351
		Date	2025/06/30
Project Name		Client Name	WEPKO
Item NO		Client Addr.	
		Contacts	Wepko
		Contact	

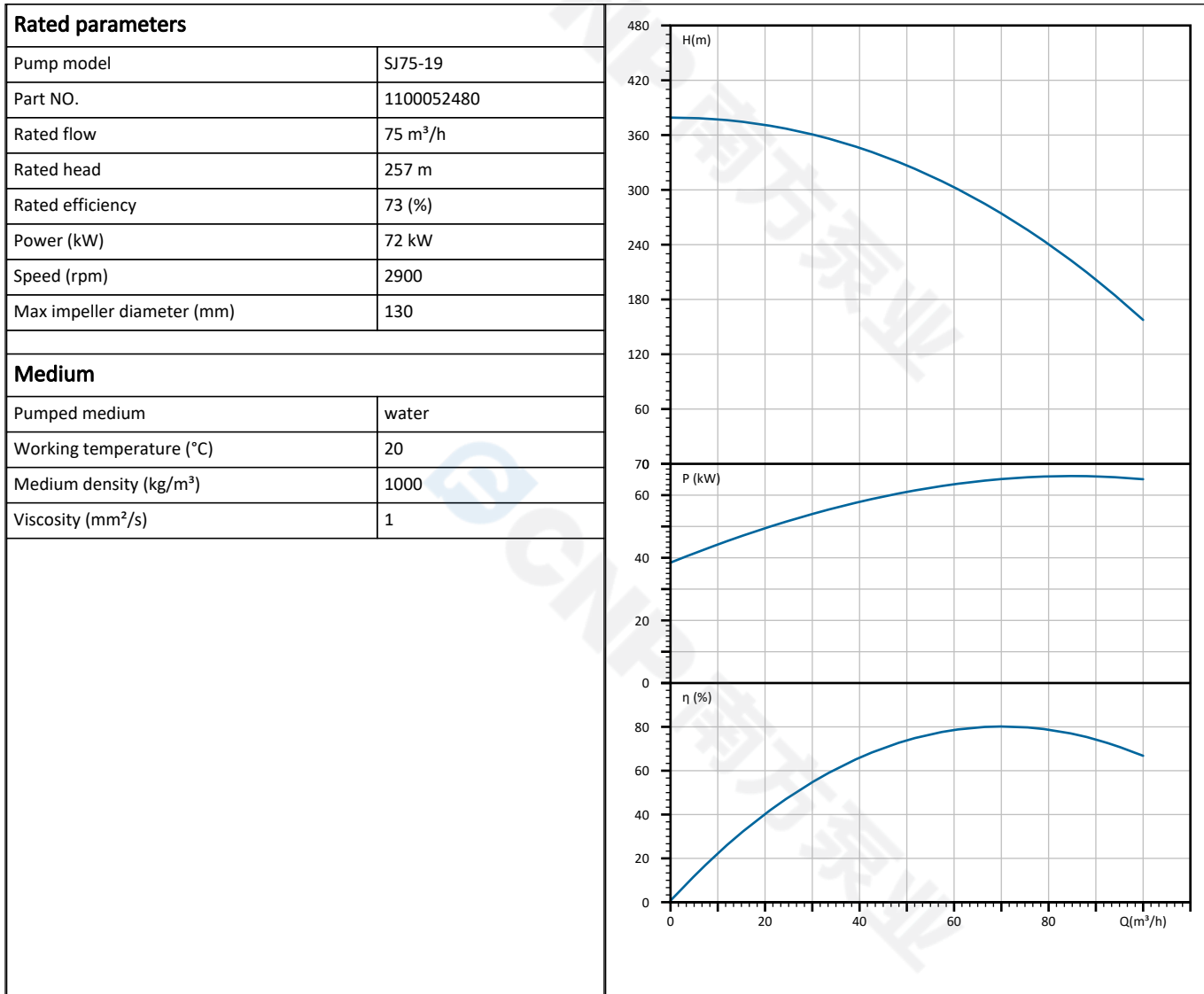

	<b>Dimension Drawing</b> <b>SJ75-19</b>	Manufacturer	Nanfang Pump Industry Co.,Ltd (CNP)
		Address	Hangzhou, Zhejiang, China
		Contact	86-571-88637351
		Date	2025/06/30
Project Name		Client Name	WEPKO
Item NO		Client Addr.	
		Contacts	Wepko
		Contact	

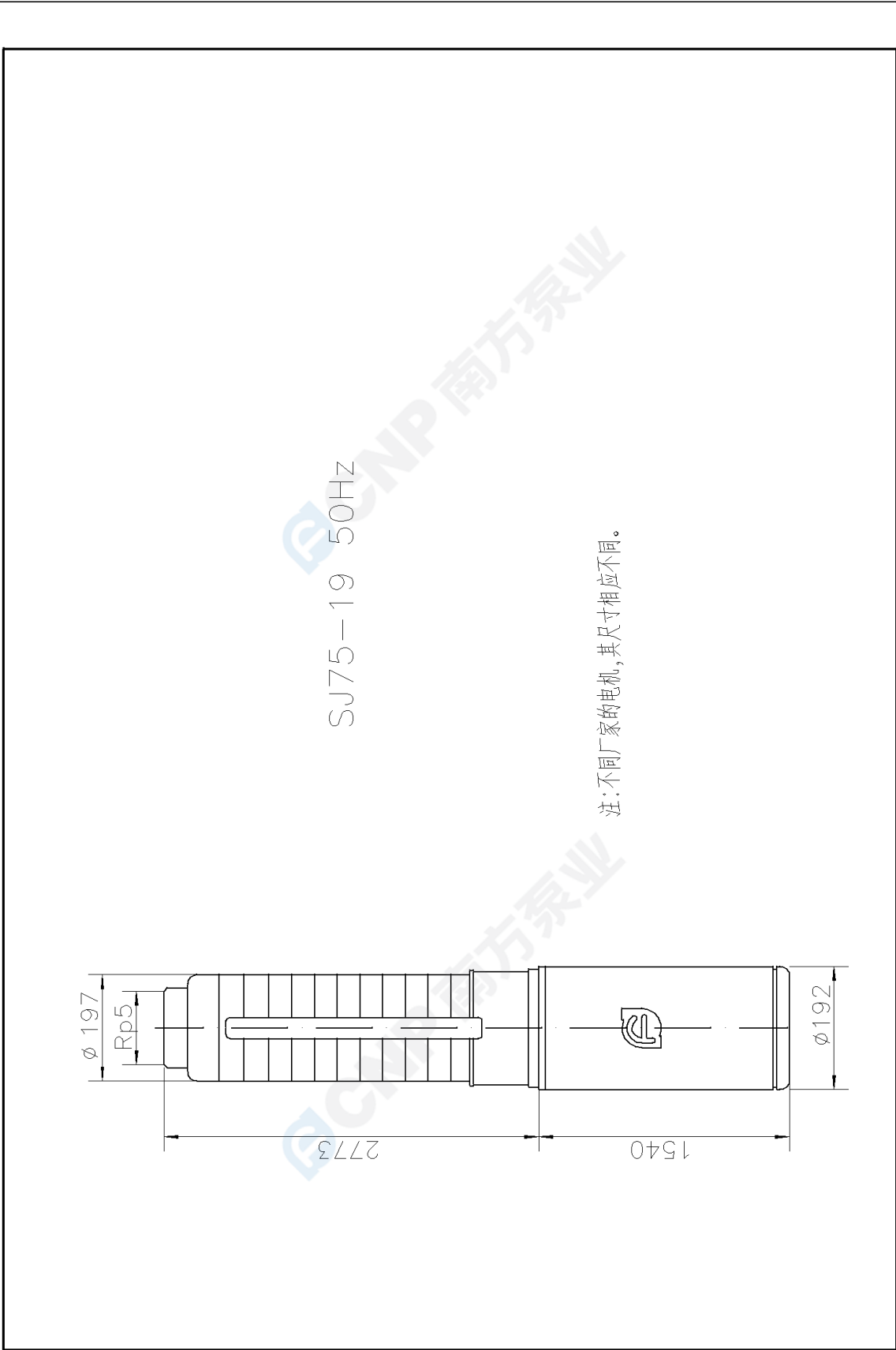

Manufacturer	Nanfeng Pump Industry Co.,Ltd (CNP)
Address	Hangzhou, Zhejiang, China
Contact	86-571-88637351
Date	2025/06/30
Client Name	WEPKO
Client Addr.	
Contacts	Wepko
Contact	

Project Name

Item NO

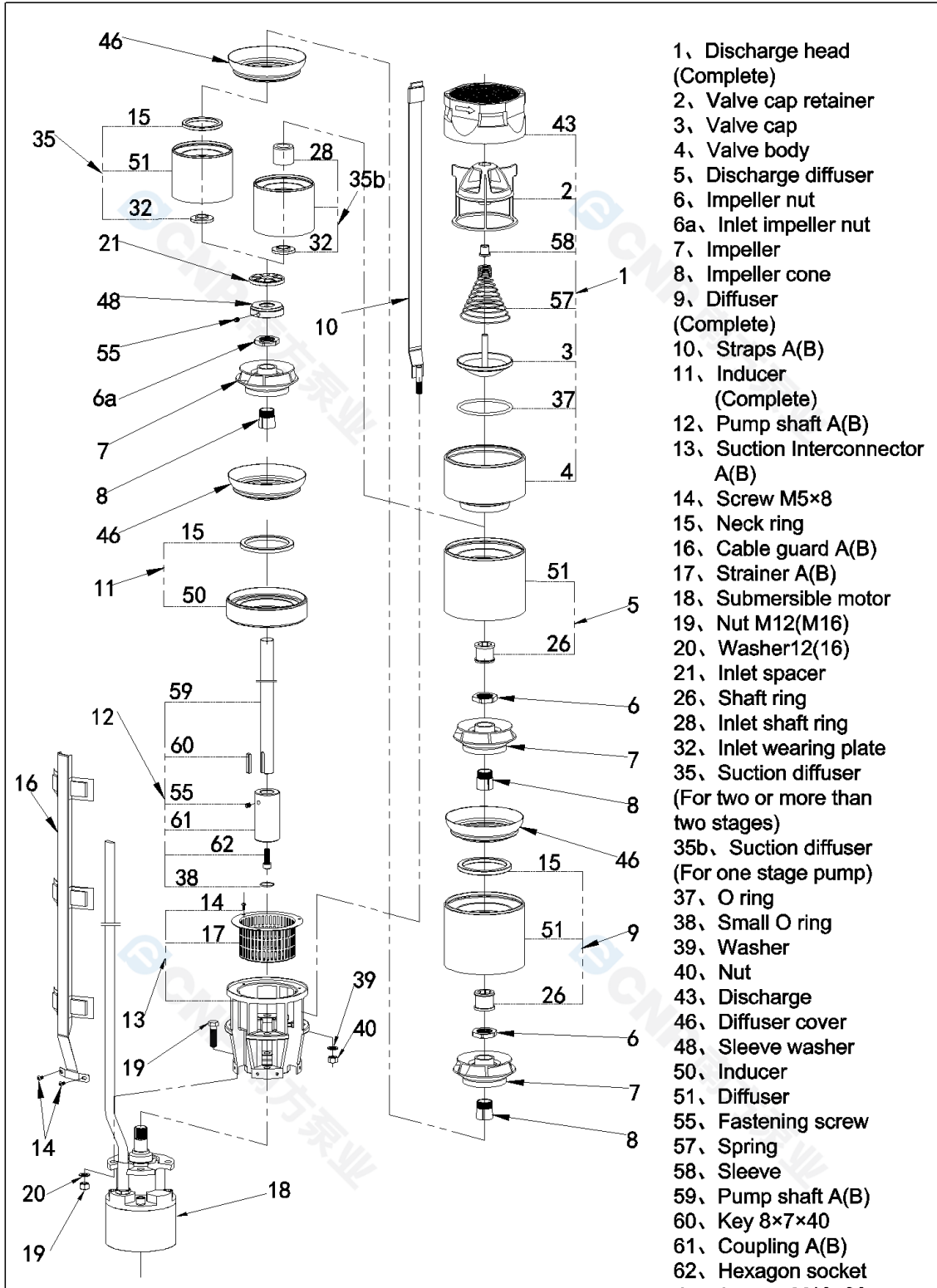

- 1、 Discharge head (Complete)
- 2、 Valve cap retainer
- 3、 Valve cap
- 4、 Valve body
- 5、 Discharge diffuser
- 6、 Impeller nut
- 6a、 Inlet impeller nut
- 7、 Impeller
- 8、 Impeller cone
- 9、 Diffuser (Complete)
- 10、 Straps A(B)
- 11、 Inducer (Complete)
- 12、 Pump shaft A(B)
- 13、 Suction Interconnector A(B)
- 14、 Screw M5×8
- 15、 Neck ring
- 16、 Cable guard A(B)
- 17、 Strainer A(B)
- 18、 Submersible motor
- 19、 Nut M12(M16)
- 20、 Washer12(16)
- 21、 Inlet spacer
- 26、 Shaft ring
- 28、 Inlet shaft ring
- 32、 Inlet wearing plate
- 35、 Suction diffuser (For two or more than two stages)
- 35b、 Suction diffuser (For one stage pump)
- 37、 O ring
- 38、 Small O ring
- 39、 Washer
- 40、 Nut
- 43、 Discharge
- 46、 Diffuser cover
- 48、 Sleeve washer
- 50、 Inducer
- 51、 Diffuser
- 55、 Fastening screw
- 57、 Spring
- 58、 Sleeve
- 59、 Pump shaft A(B)
- 60、 Key 8×7×40
- 61、 Coupling A(B)
- 62、 Hexagon socket head screw M10×30

**E-SJ 75, 95-090903**

	<b>Physical picture</b>  <b>SJ75-19</b>	Manufacturer	Nanfeng Pump Industry Co.,Ltd (CNP)
		Address	Hangzhou, Zhejiang, China
		Contact	86-571-88637351
		Date	2025/06/30
		Client Name	WEPKO
<b>Project Name</b>		Client Addr.	
<b>Item NO</b>		Contacts	Wepko
		Contact	



	<b>Order Data</b>  <b>SJ75-19</b>	Manufacturer	Nanfeng Pump Industry Co.,Ltd (CNP)
		Address	Hangzhou, Zhejiang, China
		Contact	86-571-88637351
		Date	2025/06/30
		Client Name	WEPKO
<b>Project Name</b>		Client Addr.	
<b>Item NO</b>		Contacts	Wepko
		Contact	

Pump model                    SJ75-19  
 Part NO.                        1100052480  
 Product price  
 Quantity                        1  
 Total price

---

Inquiry notes